

montážny krok 1

Obalový materiál kartón a polyetylénovú fóliu po rozbalení výrobku vhodte do kontajneru s označením papier a plasty. Po rozbalení výrobku zmontujte výrobok nasledovným spôsobom :

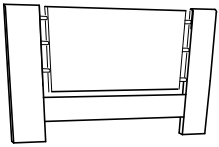

čelo CELSTE

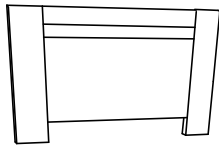

čelo MATE

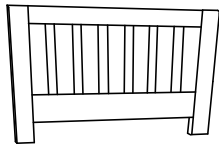

čelo ALEXA, ELIZA



čelo TINA



čelo CECILY

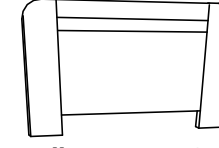

čelo KARS

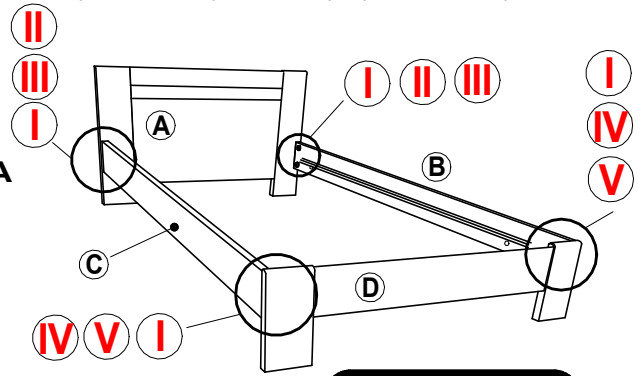

① Kolík 10x40 - 12 ks	② Sektor skrutka - 4 ks	③ Sektor podložka - 8 ks	④ Skrutka M6x65 - 4 ks	⑤ sektor. kľúč..... 1 ks
⑥ Matica M6 - 4ks	⑦ Okená podložka - 4 ks	⑧ Filcová podložka - 8 ks		

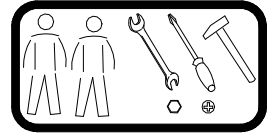

Znaky a ich vysvetlenie :

- ①, ②, ③..... MONTÁŽNE KOVANIE
- A, B, C..... DIELCE POSTELE
- ①, ②, ③..... POSTUP MONTÁŽE
- ①, ②, ③..... POSTUP KROKOV

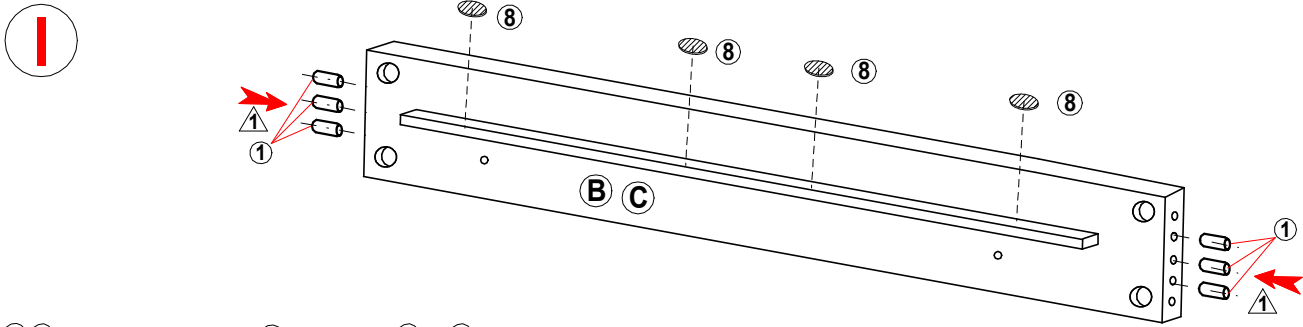
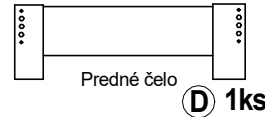
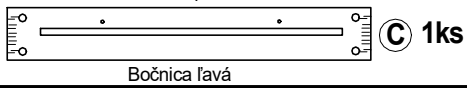
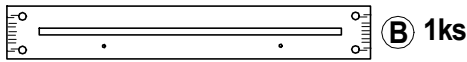

II III - Montáž zadného čela (A) s bočnicami (B) a (C)

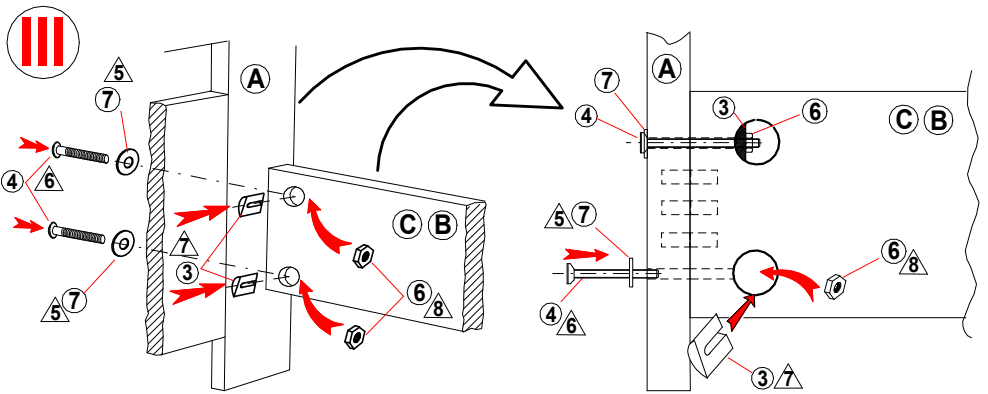
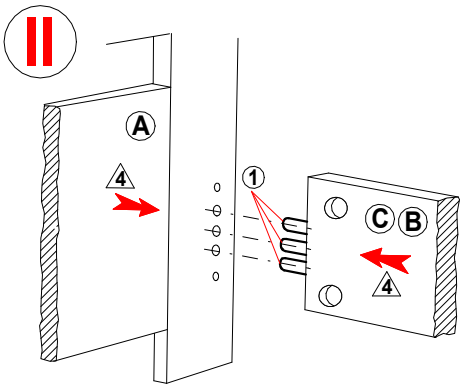

IV V - Montáž predného čela (D) s bočnicami (B) a (C)

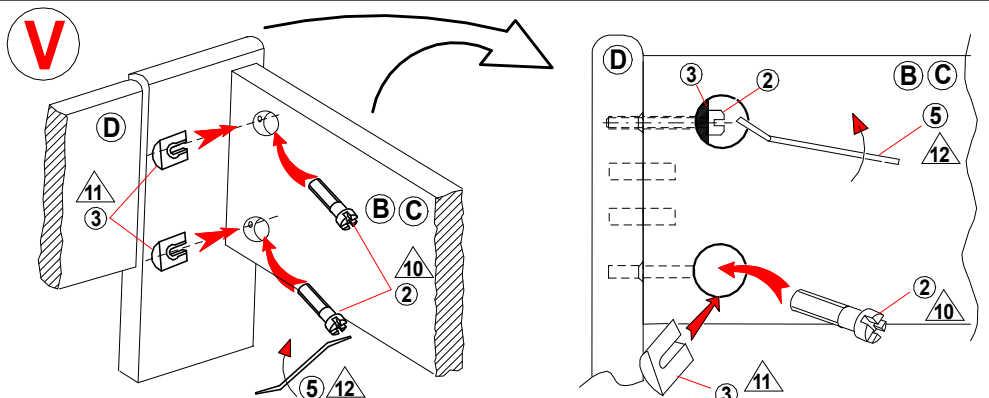
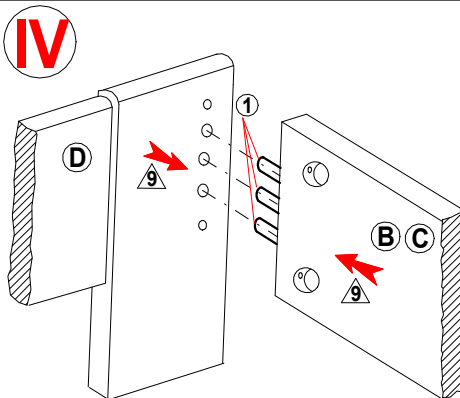

Po zmontovaní korpusu vložte rošt na naglejky postranic